

ANCHOR FOR FASTENING INSULATION TO BRICKWORK

CERTIFIED

Anchor with the CE mark in accordance with ETA, with certified resistance values. Double expansion with preassembled steel nails allows for fast versatile fastening on concrete and brickwork.

DOUBLE EXPANSION

Ø0.31 inch double expansion PVC anchor with preassembled steel nails, for fastening to concrete and brickwork. Can be used, with an additional washer, on particularly soft insulating materials.

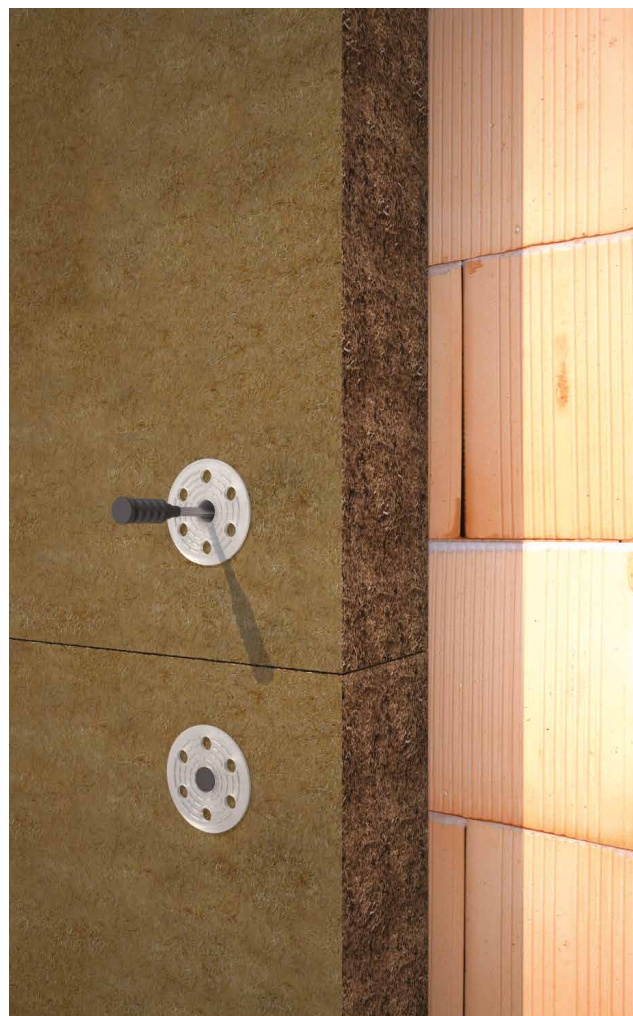

CODES AND DIMENSIONS

CODE	d _{HEAD} [in]	L [mm]	[in]	d _{HOLE} [mm]	[in]	A [in]	pcs
ISULFIX8110		110	4.38			3.13	250
ISULFIX8150	2.38	150	6.00	8	0.31	4.75	150
ISULFIX8190		190	7.50			6.25	100

A = maximum fastening thickness

CODE	d _{HEAD} [mm]	[in]	description	pcs
ISULFIX90	90	3.50	additional washer for soft insulation	250

EXPOSURE CONDITION



MATERIAL



PVC system with carbon steel nail

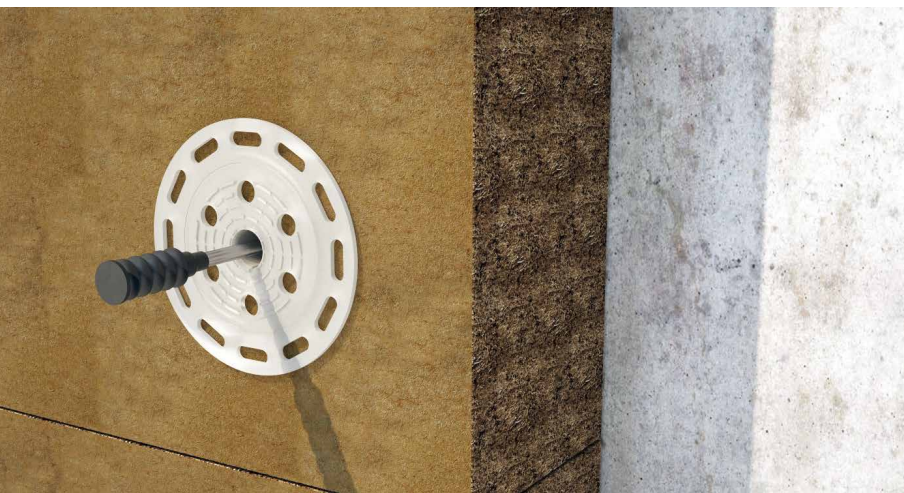

FIELDS OF USE

Anchor available in various measurements for different insulation thicknesses; can be used with an additional washer for use with soft insulation. Method of use and certified laying possibilities indicated in the relative ETA document.