

CLAW

ACCESSORY FOR GROOVE CUTTER

- Enables fast and precise milling for electrical lines and technical installations
- Compatible with Husqvarna 420EL and Stihl MSE230/MSE250 electric chainsaws

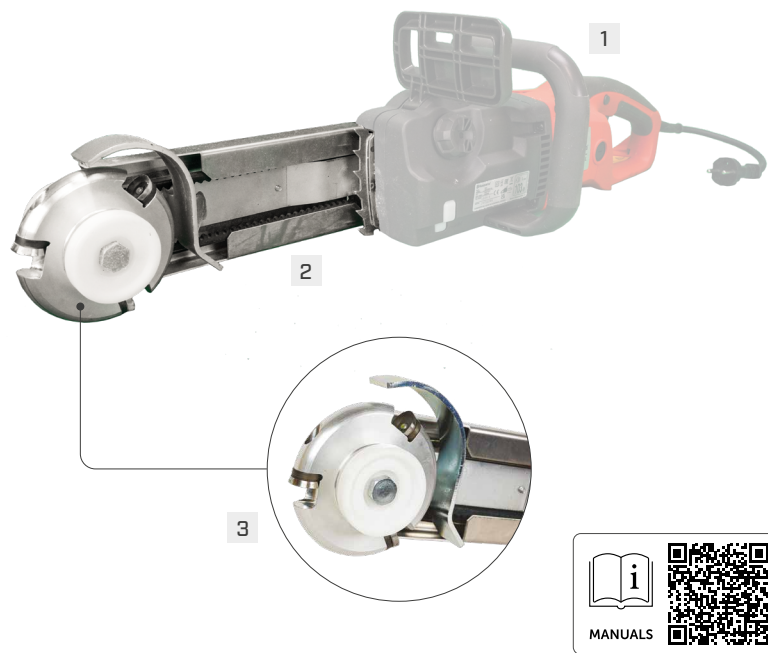

CODES AND DIMENSIONS

	CODE	description	pcs
1	PAWACLAWHQ19	Husqvarna 420EL chainsaw with mounted 19 mm 0.75" milling cutter	1
	PAWACLAWHQ24	Husqvarna 420EL chainsaw with mounted 24 mm 0.95" milling cutter	1
2	CLAWHQ19	19 mm accessory for milling cutter for Husqvarna 420EL	1
	CLAWHQ24	24 mm accessory for milling cutter for Husqvarna 420EL	1
	CLAWMSE23019	19 mm accessory for milling cutter for Stihl MSE230	1
	CLAWMSE23024	24 mm accessory for milling cutter for Stihl MSE230	1
	CLAWMSE25019	19 mm accessory for milling cutter for Stihl MSE250	1
	CLAWMSE25024	24 mm accessory for milling cutter for Stihl MSE250	1
3	GZ9FP	spare 19 mm blades	3
	GZ9FG	spare 24 mm blades	3



FOR INDOOR USE

Thanks to the electric drive, it can be used indoors without producing harmful exhaust fumes.

FIELDS OF USE

For milling between 19 and 24 mm in solid or glued laminated timber. Ideal for installing standard empty conduits. The wall can be clad immediately without creating a service cavity, saving time, money and space.